

female

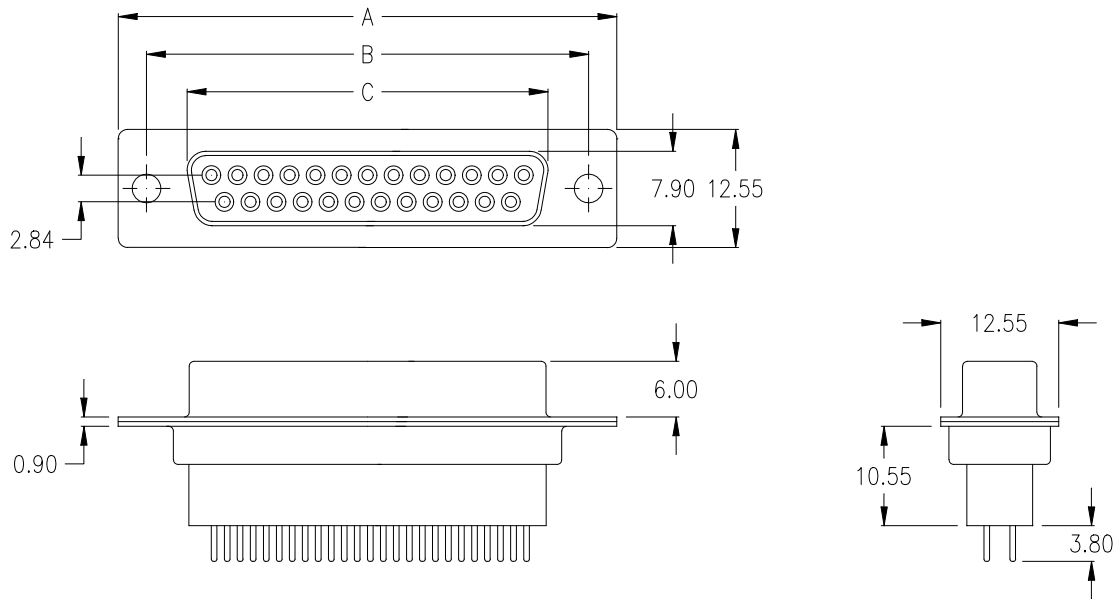

Ordering Code

SDF - xxx - B111 - 95 / XXX

No. of contacts

Option

Plating: -95 = tin(leadfree)/gold

General Specification page 72

No. of contacts	Dimension		
	A	B	C
009	30.81 1.213	24.99 .984	16.33 .643
015	39.14 1.541	33.32 1.312	24.66 .971
025	53.04 2.088	47.04 1.852	38.38 1.511
037	69.32 2.729	63.50 2.500	54.84 2.159

Options

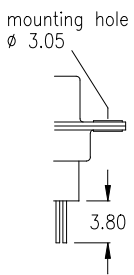

T0

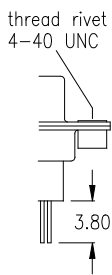

T

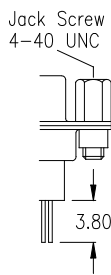

TJ

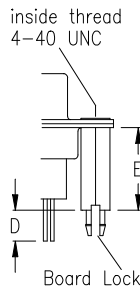

BR

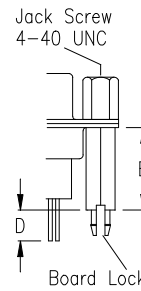

BRJ

D ±0.20	E	Option
3,20	12,70	1
3,50	11,00	2
3,20	14,50	4
4,20	13,50	5

PCB Layout „female“

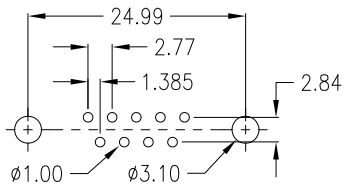

9 pin

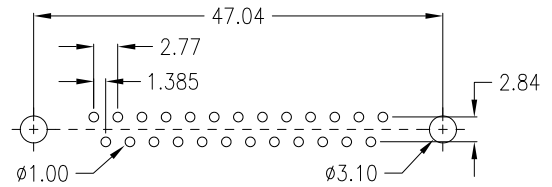

25 pin

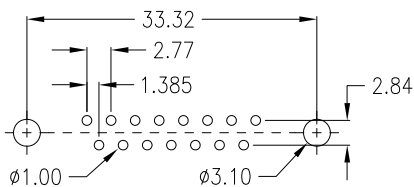

15 pin

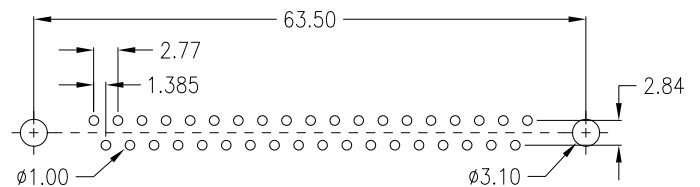

37 pin