

DR - Series DIMM Sockets for DDR Module vertical type 184-pin



DIMM sockets for DDR module are only available as long latch type (Module locking extractors).

Insertion & extraction of the module can be made without any tools.

Positive polarization prevents wrong insertion of the module.

Contacts are designed with an anti-overstress feature for long contact life. Selective Gold/Tin plated. Gold only in contact area.

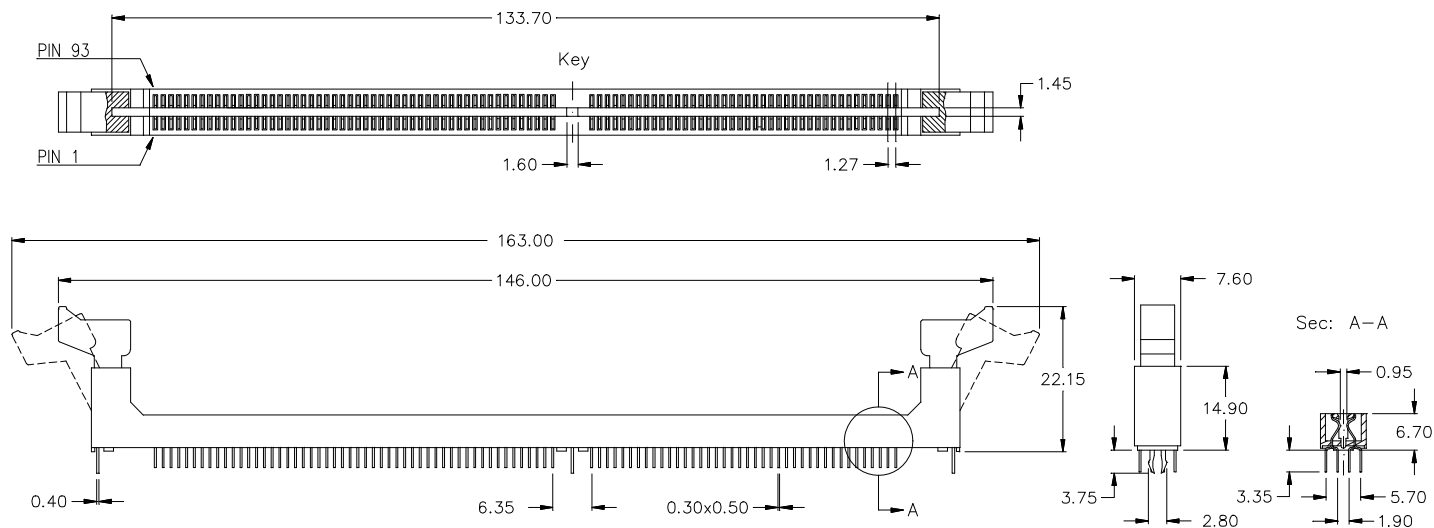

PC Board hole layout

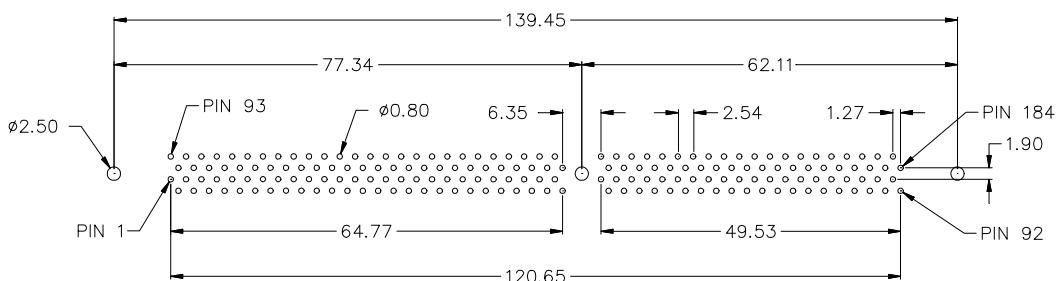

Module keying Type "A"

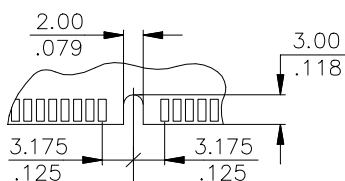

Module keying Type "B"

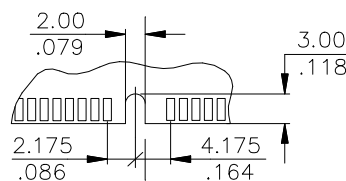

Module keying Type "C"

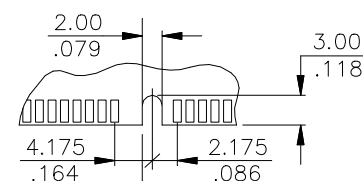

Specification

Current rating 1 A max., 250V AC
Contact resistance 30 mΩ max.
Breakdown voltage 1,5 KV RMS max.
Insulation resistance 10⁴ MΩ min.
Capacitance 1 pF max.

Operating temperature -55° C to +105° C min.
Insulator (RoHS compliant) high temp plastic UL 94 V-0
Contact (RoHS compliant) Copper Alloy
Plating Au / Sn (leadfree) over Ni

Pin	Socket Type	Voltage Key	Ordering Code
184 pin	1,8 Volt	Type "A"	Please contact E-tec sales office for availability.
184 pin	2,5 Volt	Type "B"	DR1 - 184 - VBZ9 - 95/1L
184 pin	3,3 Volt	Type "C"	Please contact E-tec sales office for availability.